

Mission Viejo Business Center

1,128 & 1,268 Square Feet Available for Lease

MISSION VIEJO, CALIFORNIA

FOR LEASE



FOR FURTHER INFORMATION, CONTACT:



GUY LAFERRARA
President
949.790.3115
glaferrara@lee-associates.com
CA License ID# 01012355

JUSTIN SMITH
Senior Vice President
949.790.3151
jbsmith@lee-associates.com
CA License ID# 01504494

Lee & Associates - Irvine, Inc.
111 Pacifica, Suite 310
Irvine, California 92618
www.lee-associates.com

No warranty or representation is made to the accuracy of the foregoing information. Terms of sale or lease and availability are subject to change or withdrawal without notice.

Mission Viejo Business Center

1,128 & 1,268 Square Feet Available for Lease

MISSION VIEJO, CALIFORNIA

PROPERTY FEATURES:

- > High-image business park
- > Office and warehouse suites available
- > Surface free parking, 2:1,000
- > 100 amp power
- > 14' warehouse clearance
- > Prominent signage
- > Ground level loading

SITE PLAN:

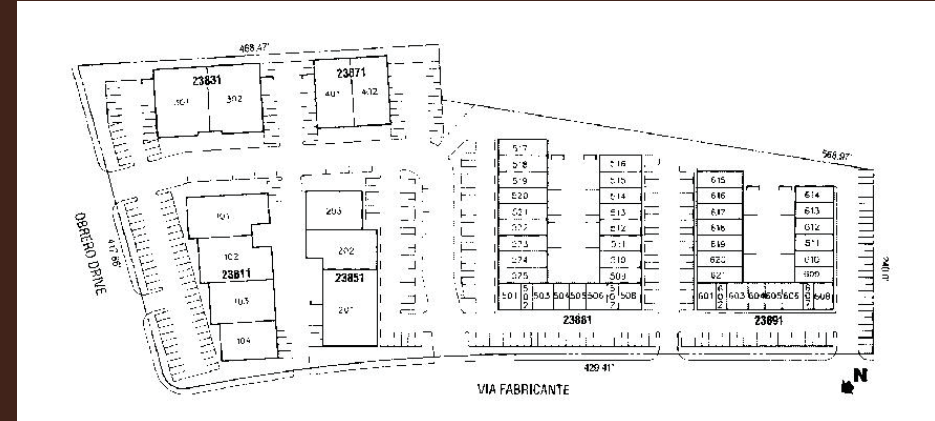

AVAILABLE FLOOR PLANS:

| PROJECT AVAILABILITY | | | | |
|----------------------|-------|----------|-----------|--|
| ADDRESS | SUITE | SIZE | RATE | DESCRIPTION |
| 23881 Via Fabricante | 510 | 1,128 SF | \$0.95 IG | Reception and one office. |
| 23891 Via Fabricante | 617 | 1,268 SF | \$0.95 IG | Reception, private office, warehouse and restroom. |

